

## Single-Acting Low Flat Hydraulic Cylinder

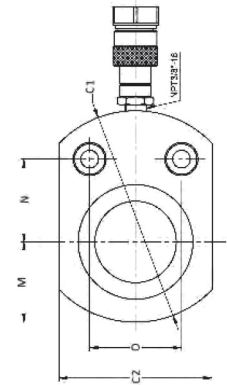

Capacity: 10-150 ton  
Stroke: 11-80 mm  
Max. Pressure: 700 bar

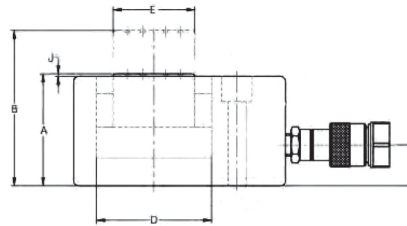

Cylinder Capacity	Stroke	Model Number	Oil Capacity	Collapsed Height	Extend Height	Outside Dia.	Cylinder Bore Dia.	Plunger Dia. (Thread)	Base to Advance port	Saddle Protrusion from Plgr.	Saddle Max. Tilt Angle	Plunger to Mounting Hole	Weight
				A	B								
ton (kN)	(mm)		(cm <sup>3</sup> )	(mm)	(mm)	(mm)	(mm)	(mm)	(mm)	(mm)	(mm)	(°)	(Kg)
10 (101)	11	SLFH 10-11	18	44	55	83x60	45	35	23	1	31.5	34	1.4
20 (201)	12	SLFH 20-12	37	52	64	102x80	63	50	23	1	41	39	2.2
30 (295)	13	SLFH 30-13	59	58	71	117x97	76	60	23	1	48.5	47	4.2
50 (435)	16	SLFH 50-16	125	67	83	150x125	100	80	23	1	63	60	7.4
75 (718)	16	SLFH 75-16	187	79	96	177x152	122	100	23	1	76.5	73	12.7
100 (887)	16	SLFH 100-16	246	87	103	203x179	140	112	23	1	89.5	84	15.5
150 (1386)	16	SLFH 150-16	371	95	111	236x212	172	145	23	1	106	92	28.7

## Double-Acting Hollow Hydraulic Cylinder



Capacity: 30-145 ton  
Stroke: 38-258 mm  
Max. Pressure: 700 bar

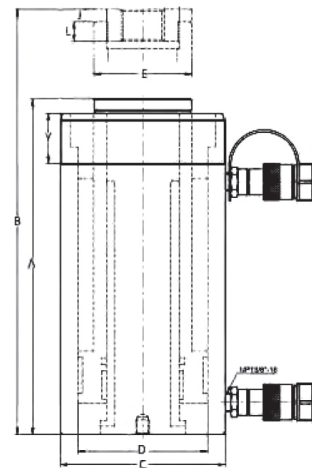

Cylinder Capacity	Stroke	Model Number	Max. Cylinder Capacity		Oil Capacity		Collapsed Height	Extend Height	Outside Dia.	Cylinder Bore Dia.	Plunger Dia. (Thread)	Weight
			Advance	Retract	Advance	Retract						
			(kN)	(kN)	(cm <sup>3</sup> )	(cm <sup>3</sup> )						
30	178	DHH 300-178	326	210	855	550	330	508	115	90	64.5	21
	258	DHH 300-258	326	210	1240	798	431	689	115	90	64.5	27
60	89	DHH 600-89	576	360	749	468	247	336	159	125	94.5	28
	166	DHH 600-166	576	360	1398	873	323	489	159	125	94.5	35
	257	DHH 600-257	576	360	2146	1352	438	695	159	125	94.5	45
95	38	DHH 1000-38	931	627	517	345	165	203	212	165	125	33
	76	DHH 1000-76	931	627	1028	692	254	330	212	165	125	61
	153	DHH 1000-153	931	627	2070	1394	342	495	212	165	125	79
	257	DHH 1000-257	931	627	3477	2341	460	717	212	165	125	106
145	203	DHH 1500-203	1429	749	4191	2198	359	562	247	190.5	150	111